

XFWI322722-xxx SERIES INDUCTORS

- * True Surface Mount Design
- * Low Cost, Extremely High Quality Product
- * Tape & Reel Packaging Standard, 2000 Pcs per 13" Reel
- * High Inductance, High Power Ratings For Your Laptop, Palmtop, Point of Power Application
- * Custom Versions Available At No Extra Charge

Dimensions:

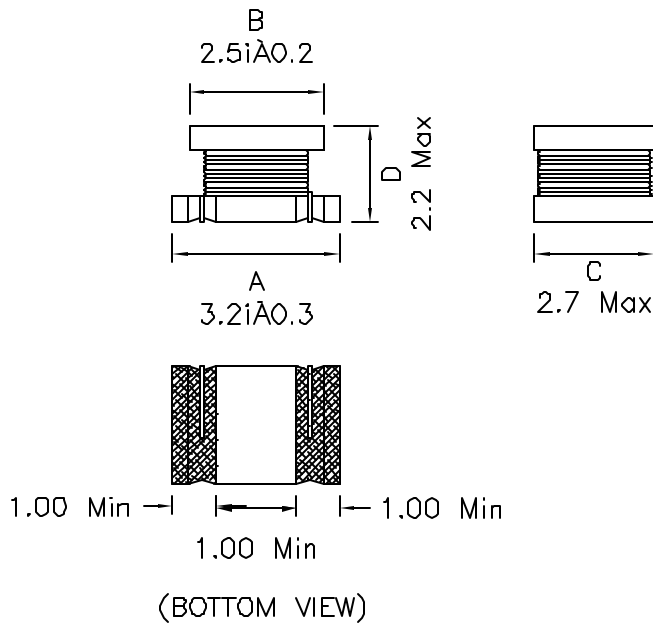

Schematic:

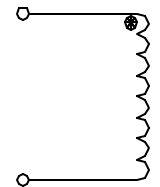

UNLESS OTHERWISE SPECIFIED
TOLERANCES:

N/A

Dimensions in MM

Part Number	Inductance (uH)	Q Typ	Q MEASURED AT MHz	DCR Max (OHMS)	SRF MHz Min.	I RATED (mA)
XFWI322722-R10M	0.1	20	25.2	0.25	200	700
XFWI322722-R18M	0.18	20	25.2	0.25	200	650
XFWI322722-R27M	0.27	25	25.2	0.25	200	600
XFWI322722-R39M	0.39	25	25.2	0.25	200	530
XFWI322722-R56M	0.56	30	25.2	0.25	160	530
XFWI322722-R68M	0.68	30	25.2	0.25	160	470
XFWI322722-R82M	0.82	30	25.2	0.25	120	450

TEST CONDITIONS: 100KHz, 0.1V
 M \pm 20% K \pm 10%

XFWI322722-xxx SERIES INDUCTORS

Part Number	Inductance (uH)	Q Typ	Q MEASURED AT MHz	DCR Max (OHMS)	SRF MHz Min.	I RATED (mA)
XFWI322722-1R0M	1	20	1	0.5	100	445
XFWI322722-1R2M	1.2	20	1	0.6	100	425
XFWI322722-1R5K	1.5	20	1	0.6	75	400
XFWI322722-1R8K	1.8	20	1	0.7	60	390
XFWI322722-2R2K	2.2	20	1	0.8	50	370
XFWI322722-2R7K	2.7	20	1	0.9	43	320
XFWI322722-3R3K	3.3	20	1	1	38	300
XFWI322722-3R9K	3.9	20	1	1.1	35	290
XFWI322722-4R7K	4.7	20	1	1.2	31	270
XFWI322722-5R6K	5.6	20	1	1.3	28	250
XFWI322722-6R8K	6.8	20	1	1.5	25	240
XFWI322722-8R2K	8.2	20	1	1.6	23	225
XFWI322722-100K	10	35	1	1.8	20	190
XFWI322722-120K	12	35	1	2	18	180
XFWI322722-150K	15	35	1	2.2	16	170
XFWI322722-180K	18	35	1	2.5	15	165
XFWI322722-220K	22	35	1	2.8	14	150
XFWI322722-270K	27	35	1	3.1	13	125
XFWI322722-330K	33	40	1	3.5	12	115
XFWI322722-390K	39	40	1	3.9	11	110
XFWI322722-470K	47	40	1	4.3	11	100
XFWI322722-560K	56	40	1	4.9	10	85
XFWI322722-680K	68	40	1	5.5	9	80
XFWI322722-820K	82	40	1	6.2	8.5	70
XFWI322722-101K	100	40	0.796	7	8	80
XFWI322722-121K	120	40	0.796	7.5	8	75
XFWI322722-151K	150	40	0.796	9.3	7	70
XFWI322722-181K	180	40	0.796	10.2	6	65
XFWI322722-221K	220	40	0.796	11.8	5.5	65
XFWI322722-271K	270	40	0.796	12.5	5	65
XFWI322722-331K	330	40	0.796	13	5	65
XFWI322722-391K	390	50	0.796	22	5	50
XFWI322722-471K	470	50	0.796	25	5	45
XFWI322722-561K	560	50	0.796	28	5	40

TEST CONDITONS: 100KHz, 0.1V
 M±20% K±10%